

# MiLO® Cleaning Instructions

1

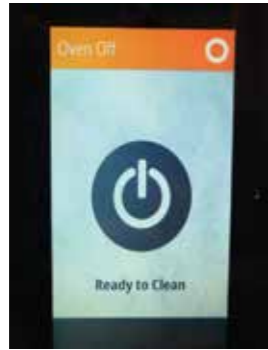

Turn off oven by touching the power symbol. Wait for the cooling fans to shut off, and for the screen to display "Ready To Clean"

2

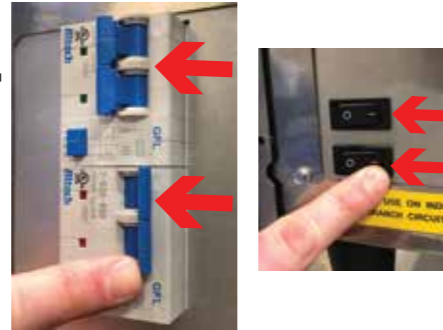

Move the control reset switch to off. Flip the GFCI switch (or 2 switches, depending on the oven) to off (which is green).

3



Open the door. Remove rack, wipe down with damp\* non-abrasive cloth. Wipe all interior surfaces of oven cavity, including door. DO NOT SPRAY INTO CAVITY.

4

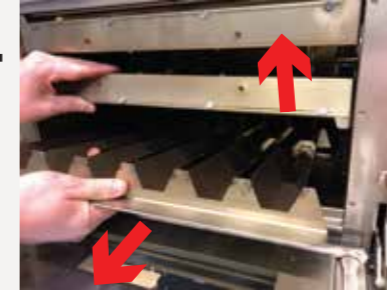

Raise the element pack on the bottom of the oven, and remove the crumb tray from beneath. Set the crumb tray aside. You do not need to do anything with the top.

5



Use a damp cloth to clean underneath the jet pack. Follow with a dry cloth, and allow to air dry completely.

6



Remove and clean the drip tray. Lift up the tray, tilting the bottom outwards to release the tabs. Spray and wipe down as needed.

7



Remove all three (3) air filters, Spray with water/soap to clean. Set aside and allow to air dry completely before reinstalling.

8



Scrub/ soak drip tray, cooking racks, crumb tray as needed. Rinse and allow to air dry completely before reinstalling.

9



Reinstall drip tray, crumb tray, cooking racks.

10



Polish and clean the exterior of the oven with a commercial-grade stainless steel polish.

\* Use ONLY a non-caustic degreaser on the oven and components. Noncompliance will void oven warranty. Pictures are representative/ may vary.

Call Ovention Customer Care at 855.298.6836

\*\*Frequency and depth of cleaning is dependent on the type of use your machine is subjected to. Refer to your product manual (available on our website) for additional cleaning options.